



General notes

All setting out must be checked on site
All levels must be checked on site and refer to
Ordnance Datum Newlyn unless alternative Datum given
All fixings and weathersings must be checked on site
All dimensions must be checked on site
This drawing must not be scaled
This drawing must be read in conjunction with all other
relevant drawings, specification clauses and current design risk
register
This drawing must not be used for land transfer purposes
Calculated areas in accordance with Assael Architecture's
Definition of Areas for Schedule of Areas
This drawing must not be used on site unless issued for
construction
Subject to survey, consultation and approval from all statutory
Authorities

Revision Status:
P=Preliminary
C=Contract

© 2017 Assael Architecture Limited

Assael Architecture Limited has prepared this document in
accordance with the instructions of the Client under the agreed
Terms of Appointment. This document is for the sole and specific
use of the Client and Assael Architecture shall not be responsible
for any use of its contents for any purpose other than that for
which it was prepared and provided. Should the Client require to
pass electronic copies of the document to other parties, this
should be for co-ordination purposes only, the whole of the file
should be so copied, but no professional liability or warranty shall
be extended to other parties by Assael Architecture in this
connection without the explicit written agreement thereto by
Assael Architecture Limited.

Drawing notes

Electronic file reference

A2874 Eynsham Drive Plans Working

| Status R: | Revision | Date | DRN | CHK | CDM |
|-----------|-------------------|----------|-----|-----|-----|
| 20 | Planning Addendum | 19/09/18 | CS | ES | |

Application boundary

Purpose of information

The purpose of the information on this Planning
drawing is for:

- ☐ Information
☒ Information
☐ Comment
☐ Client approval
☐ Construction

All information on this drawing is not
for construction unless it is marked
for construction.

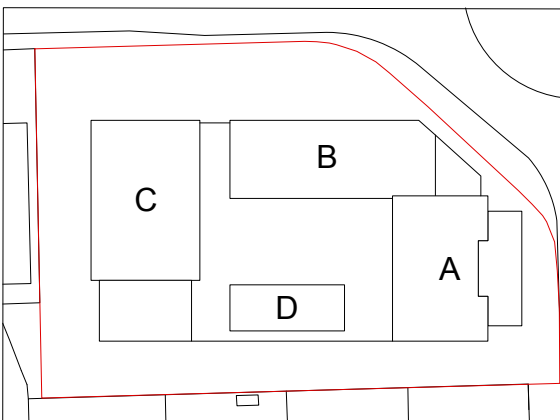

Client

**Abbey Wood
Property Ltd**

Project title

**Eynsham Drive
Abbey Wood**

Drawing title

**Proposed Plan
Seventh Floor**

Scale @ A1 size

Date

1:200

Feb '17

Drawing N°

Status & Revision

A2874 207

R20

Assael

Assael Architecture Limited
123 Upper Richmond Road
London SW15 2TL

+44 (0)20 7736 7744
info@assael.co.uk
www.assael.co.uk